



SONOMA COUNTY MUSEUM

CONNECTING THE REGION'S HISTORY WITH ART AND CULTURE



SONOMA COUNTY MUSEUM

The Sonoma County Museum is housed in the charming, historic 1909 Beaux-Arts former post office in downtown Santa Rosa. The Museum celebrates and interprets the region's rich history, art, and culture by exhibiting and collecting relevant objects and artworks, by serving as a vital community gathering place, and by inspiring visitors with dynamic experiences that engage, educate, and enlighten. The Museum holds a noted permanent collection of Sonoma County historic art and artifacts as well as the definitive Christo & Jeanne-Claude collection.



MAIN GALLERY

Engage in dynamic and innovative exhibitions that range from art to history, with a special emphasis on the region's land, culture and environment.



CONTEMPORARY PROJECT SPACE



Enter into a unique gallery space dedicated to showcasing the latest in contemporary art.

HISTORY GALLERY

View art and artifacts from the Museum's permanent collection. Listen to stories from the Oral History Project and experience personal stories of the past.



CHRISTO & JEANNE-CLAUDE GALLERY

The Museum is home to the largest collection of artworks by Christo & Jeanne-Claude in the U.S. This gallery features original works by the artists who create major land art projects throughout the world.

OUTDOOR ARTS

On Museum grounds discover temporary nature-based projects created by artists, as well as large-scale sculpture.



ENGAGE...

Throughout the year, the Museum offers visitors many opportunities to experience the region's wealth of art and culture. For the latest calendar of events, please visit our website at www.sonomacountymuseum.org.

* EDUCATION PROGRAMS

The Museum & Schools Program assists teachers with arts, history and science education. The Museum provides free tours, bus funds and educational materials.

* FREE FAMILY DAYS

Bring family and friends to the Museum for afternoons of interactive explorations and hands-on art activities.



* DOCENT TOURS

The Museum offers docent-led tours seven days a week, by appointment to groups of 10-40 people.

* EVENTS + ENRICHMENT

Join others in the Museum's many public programs such as artist's talks, openings, studio tours and lecture series.

* MEMBERSHIP

Join today and benefit!

Please call the Museum regarding membership and event reservations at 707-579-1500 x13. For information on the Museum & Schools Program, or to schedule a docent-led tour, call 707-579-1500 x19.

Front cover: *Running Fence*, Christo and Jeanne-Claude; *Tom Wing Family Portrait*, ca.1917. Inside (clockwise from upper right): *Santa Rosa Post Office ca.1911*; *Sequoia*, Bruce Johnson; *Art Toon Mural*, ArtStart; *Bottle with Two Openings*, Marguerite Wildenhain; *fern space blast (detail)*, Chris Natrop; *Quail Hill, Freestone (detail)*, Jack Stuppin

GALLERY MAP

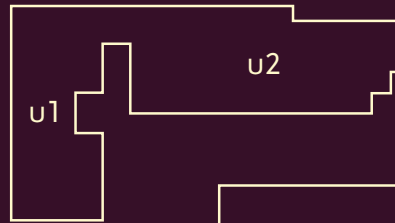

UPSTAIRS

U1: CHRISTO & JEANNE-CLAUDE GALLERY

U2: HISTORY GALLERY

DOWNSTAIRS

D1: MAIN GALLERY

D2: CONTEMPORARY PROJECT SPACE

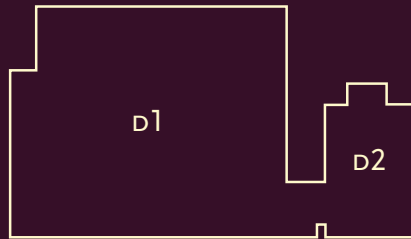

MUSEUM SHOP

Bring home beautifully crafted work by well known Sonoma County designers and artists. Jewelry, art, pottery, textiles and more — as well as books on art, architecture and local history.



HOURS + ADMISSION

Wednesday through Sunday, 11 am to 5 pm.

\$5 adults, \$2 students, seniors (65+), and disabled.

FREE to SCM members and children under 12.

LOCATION

The Sonoma County Museum is located in downtown Santa Rosa just north of the Macy's parking lot at the Santa Rosa Plaza. From Hwy. 101 South, take the Downtown/Third St. exit. From 101 North, take the Davis St. exit.



SONOMA COUNTY MUSEUM



425 7TH STREET, SANTA ROSA, CA 95401
PH (707) 579-1500 FAX (707) 579-4849

INFO@SONOMACOUNTYMUSEUM.ORG

WWW.SONOMACOUNTYMUSEUM.ORG